

TC UNION

Manufacture Material

ASTM A182 TP
TP 304/L and 316/L

Surface Finishing

PI/PE: $Ra < 0,80 \mu m$ (32 μin)
Mechanical Polishing

Seal

EPDM
Silicone
PTFE
Envelope PTFE/EPDM
Viton

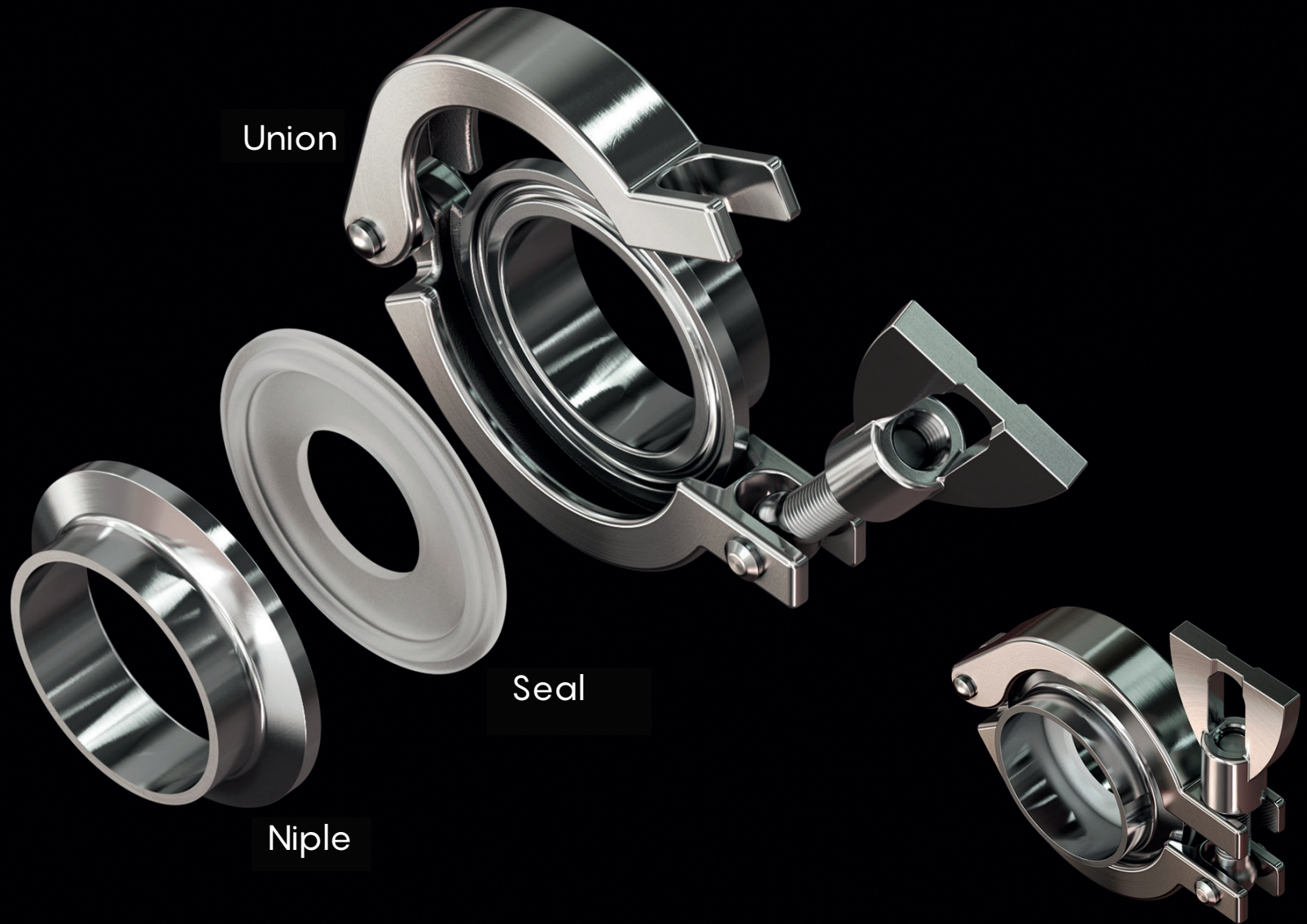

X-STEEL

TC UNION

Union

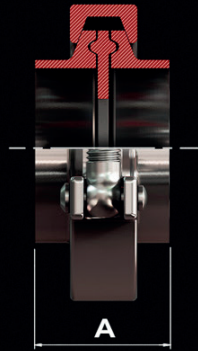

Niple

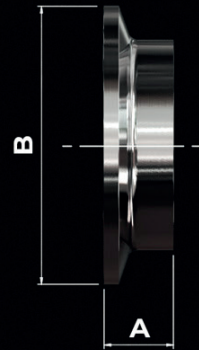

Seal

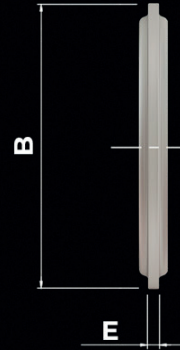

Clamp

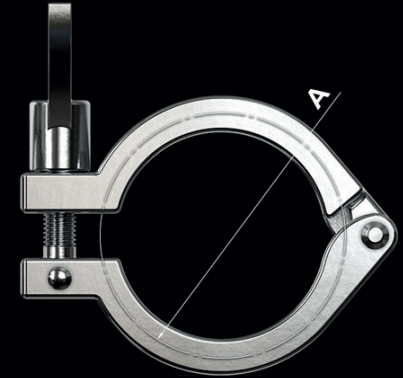

Ø	A	
	Short	Long
1/2"	27,1	44,7
3/4"	27,1	44,7
1"	27,1	59,0
1.1/2"	27,1	59,0
2"	27,1	59,0
2.1/2"	27,1	59,0
3"	27,1	59,0
4"	33,3	59,0
6"	33,3	59,0
8"	33,3	59,0

Ø	A			B
	Short	Long	Orbital	
1/2"	12,7	21,5	44,5	25,2
3/4"	12,7	21,5	44,5	25,2
1"	12,7	28,6	44,5	50,5
1.1/2"	12,7	28,6	44,5	50,5
2"	12,7	28,6	57,2	64,0
2.1/2"	12,7	28,6	57,2	77,5
3"	12,7	28,6	57,2	91,0
4"	15,8	28,6	76,2	119,0
6"	15,8	28,6	76,2	167,0
8"	15,8	28,6	76,2	218,0

Ø	B	E
1/2"	27,5	1,7
3/4"	27,5	1,7
1"	52,7	1,7
1.1/2"	52,7	1,7
2"	66,2	1,7
2.1/2"	79,7	1,7
3"	93,2	1,7
4"	121,2	1,7
6"	169,2	1,7
8"	220,2	1,7

Ø	A
1/2"	29
3/4"	29
1"	54
1.1/2"	54
2"	67
2.1/2"	81
3"	94
4"	122
6"	171
8"	233