

# RJT UNION

## Manufacture Material

ASTM A182  
TP 304/L and 316/L

## Surface Finishing

PI/PE: Ra < 0,80 µm (32 µin)  
*Mechanical Polishing*

## Seal

EPDM  
Silicone  
Viton

## Standards and Gauges

*Dimensions as per standard  
BS 1864*



**X-STEEL**

# RJT UNION

Union

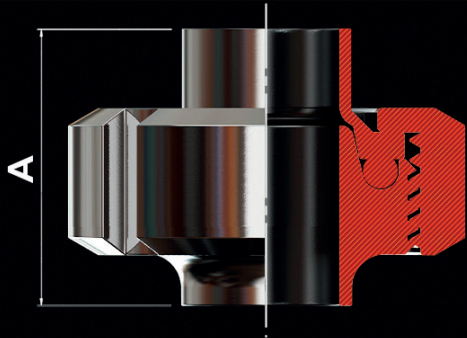

Nut

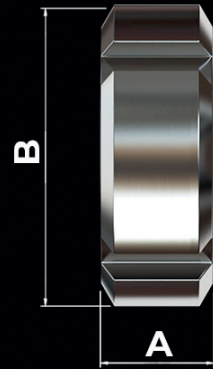

Niple

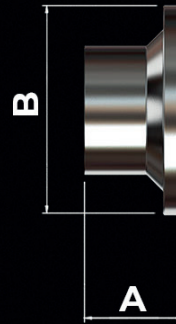

Seal

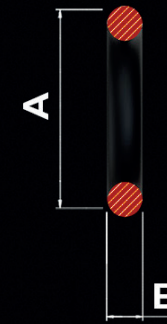

Male

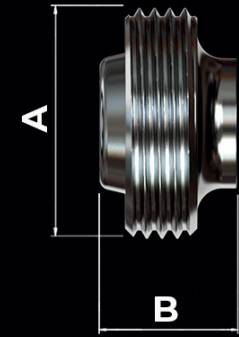

| Ø      | A    |
|--------|------|
| 1"     | 41,7 |
| 1.1/2" | 41,7 |
| 2"     | 41,7 |
| 2.1/2" | 41,7 |
| 3"     | 41,7 |
| 4"     | 41,7 |

| A    | B     |
|------|-------|
| 22,2 | 58,5  |
| 22,2 | 74,0  |
| 22,2 | 85,5  |
| 22,2 | 98,5  |
| 22,2 | 111,6 |
| 22,2 | 138,0 |

| A    | B     |
|------|-------|
| 19,5 | 41,3  |
| 19,5 | 54,0  |
| 19,5 | 66,7  |
| 19,5 | 79,4  |
| 19,5 | 92,1  |
| 19,5 | 117,5 |

| A     | B   |
|-------|-----|
| 39,0  | 6,5 |
| 52,0  | 6,5 |
| 65,0  | 6,5 |
| 78,0  | 6,5 |
| 90,0  | 6,5 |
| 116,0 | 6,5 |

| A     | B    |
|-------|------|
| 45,7  | 22,2 |
| 58,4  | 22,2 |
| 72,7  | 22,2 |
| 85,4  | 22,2 |
| 98,1  | 22,2 |
| 123,5 | 22,2 |